

SFMZ



Sleeve Filter System
SFMZ

ZACCARIA

Sleeve Filter System SFMZ

Due to the growing demand for cleaner environments in food industry, Zaccaria has developed an accurate line of sleeve filters to attend this need in milling industries of rice, maize, beans and several other cereals.

These equipment works using the principle of pulsating jet cleaning, which is currently the most efficient system for sleeve filters cleaning, and, can be offered in various sizes to suit different needs, from 130m³/min to 1000m³/min.

CONSTRUCTIVE FEATURE

- Strong structure manufactured in carbon steel SAE 1020
- Special painted with Epoxy and Pu, thus can be exposed to weather
- Cage of the sleeves composed by galvanized wire
- Sleeve filter composed by acrylic fiber, however can be offered in other material to attend special needs

WORKING PRINCIPLE

The air containing impurities particle gets in the equipment through the opening located between the box and the hopper, then goes through the filter where the impurities are retained and goes down to the hopper, while the airflow pass through the sleeve, returning clean to the environment.

CLEANING SYSTEM OF THE SLEEVES

The pulsating jet consists in “shots” of air injection through a Venturi accelerator, which makes a high amount of air being tossed inside the sleeve filter, resulting in a shock wave moving the filter cloth, knocking the impurities particle down to the hopper.

The line of sleeve filters Zaccaria also features an exclusive system that discharges another pulse of compressed air inside the hopper, eliminating the impurity accumulation problem.

The interval between those discharges, as well as its potency, can be controlled and adjusted by an electronic time.

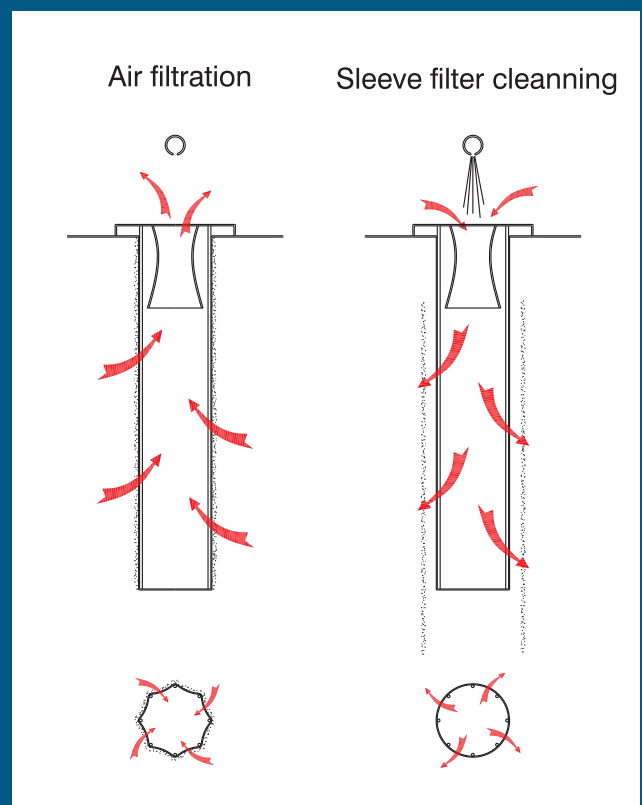

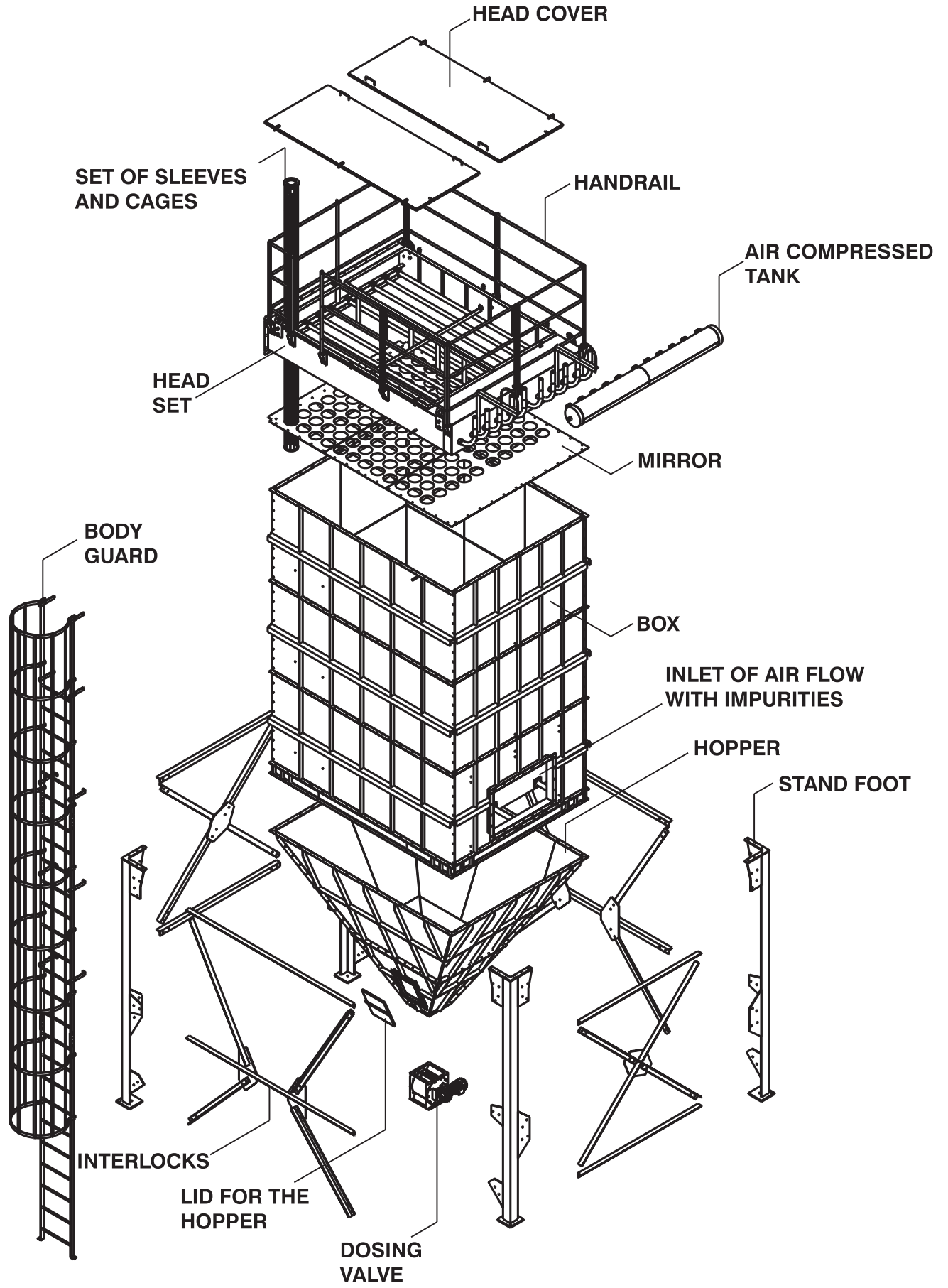

SFMZ

Sleeve Filter System SFMZ

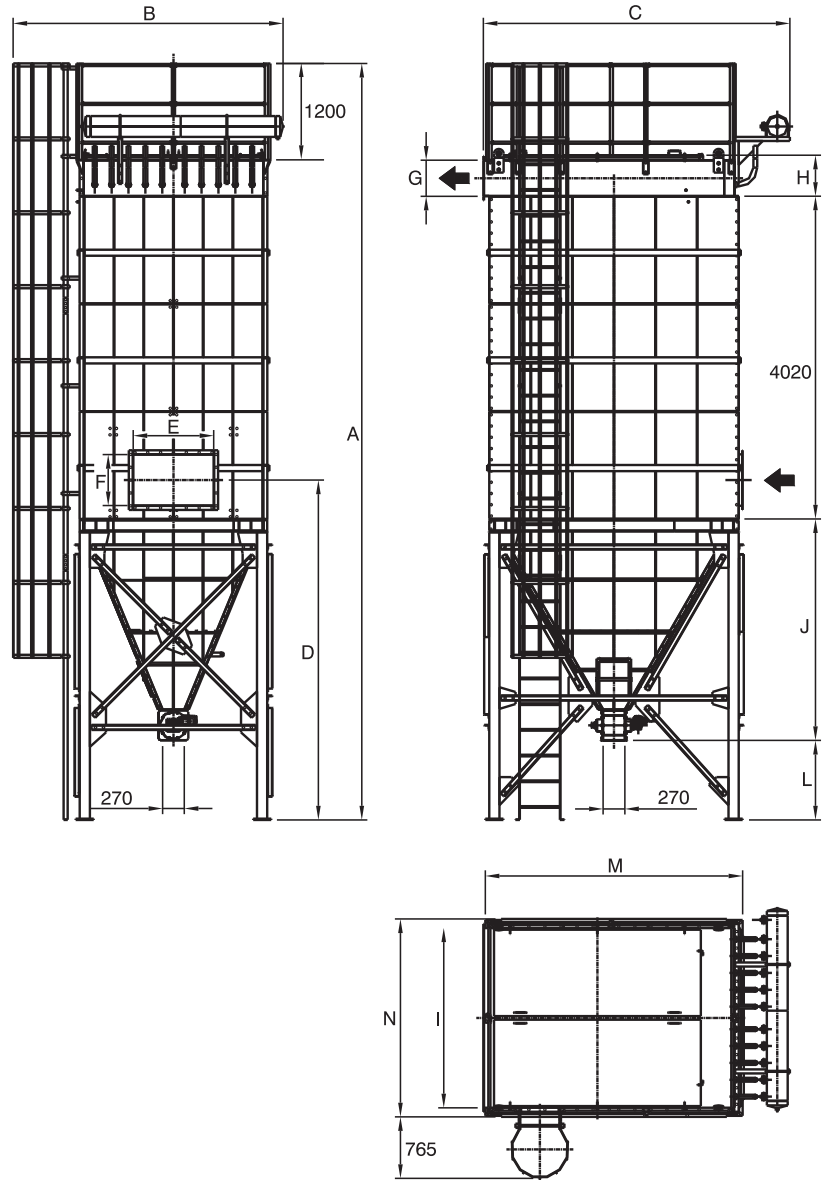

| Models | Size | Filtering Area (m ²) | Dimensions (mm) | | | | | | | | | | | | | weight (kg) |
|------------------|---------|----------------------------------|-----------------|------|------|------|------|-----|-----|-----|------|------|------|------|------|-------------|
| | | | A | B | C | D | E | F | G | H | I | J | L | M | N | |
| SFMZ-130 | 4 x 7 | 66 | 8570 | 2160 | 2830 | 3720 | 710 | 250 | 300 | 340 | 1000 | 1890 | 1160 | 2160 | 1090 | 1400 |
| SFMZ-230 | 6 x 9 | 110 | 8680 | 2560 | 3080 | 3600 | 740 | 550 | 300 | 340 | 1400 | 2140 | 1020 | 2400 | 1490 | 2000 |
| SFMZ-370 | 9 x 10 | 180 | 9025 | 3400 | 3080 | 3950 | 890 | 560 | 300 | 340 | 2240 | 2340 | 1160 | 2400 | 2330 | 3700 |
| SFMZ-500 | 10 x 12 | 236 | 9420 | 3360 | 3820 | 4230 | 1000 | 630 | 440 | 510 | 2230 | 2760 | 990 | 3210 | 2460 | 4090 |
| SFMZ-760 | 11 x 14 | 304 | 9710 | 3640 | 4150 | 4450 | 1290 | 690 | 400 | 590 | 2490 | 3000 | 940 | 3460 | 2600 | 4270 |
| SFMZ-840 | 12 x 14 | 330 | 10050 | 3850 | 4150 | 4790 | 1510 | 750 | 440 | 650 | 2700 | 3340 | 940 | 3460 | 2810 | 4400 |
| SFMZ-1000 | 15 x 14 | 415 | 10390 | 4480 | 4150 | 5130 | 2140 | 810 | 440 | 690 | 3120 | 3680 | 940 | 3460 | 3440 | 4670 |

PS: 1- All models include rotary valve, to discharge the impurities, powered by gear motor of 1,1 kW / 1,5 hp / IV poles.

2 - Fan, connection pipes between filter and fan, chimney (optional) and noise reducer (optional) are particular in each project.

Indústrias Machina Zaccaria S/A reserves the right to change the information contained in this catalog, including the color and details of the machine, without previous notice.

ZACCARIA

OUR EXPERIENCE MAKES THE DIFFERENCE

INDÚSTRIAS MACHINA ZACCARIA S/A
 Rua Laranjal, 180
 CEP: 13484-016 - Limeira - SP - Brasil
 Phone: (55.19) 3404-5725
 Fax: (55.19) 3404-5720

www.zaccaria.com.br
comex@zaccaria.com.br

