

# SFMZ



Sleeve Filter  
**SFMZ**

**ZACCARIA**

# Sleeve Filter SFMZ

Due to the growing demand for cleaning, Zaccaria has developed the Sleeve Filters, models SFMZ to attend the need of the milling industries of rice, maize, beans and other cereals.

The SFMZ works using the principle of pulsating jet cleaning, which in the current days is the most efficient system for sleeve filters.

Zaccaria has available several options of sleeve filters, suitable for different needs of the industries.

## CONSTRUCTIVE FEATURE

- Strong structure manufactured by carbon steel SAE 1020
- Special painting, with Epoxy and Pu, for the resistance against for the exposition to the weather in open areas
- Cages of sleeves composed by galvanized wire
- Sleeve filters manufactured by acrylic fiber, however, they can be offered by other material to attend special needs (under consult)

## WORKING PRINCIPLE

The air and the particles of impurities get inside the equipment from the bottom. As well as the volume increases, the particle speed decreases, which ones stay retained from the outside of the sleeves, meanwhile the cleaned air goes through the sleeve filters and then, released to the environment.

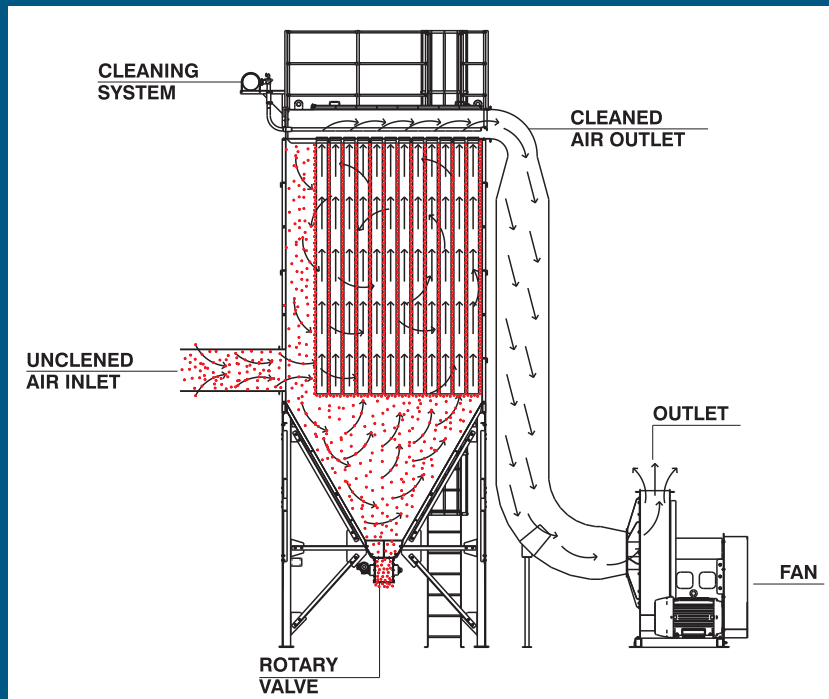

## CLEANING SYSTEM OF THE SLEEVES

The Sleeves have a pulsating jet system. It consists in some shots of air injected through accelerated system. The shots are injected in the count-flow of the filtering. The impurities particles are detached from the sleeves and they follow down, to the bottom of the equipment.

The line of Sleeve Filters from Zaccaria features an exclusive system at discharging. It has another pulse of air inside the hopper, eliminating the accumulation of impurities.



Illustrative picture (assembly with filter, fan, pipes and noise attenuator).

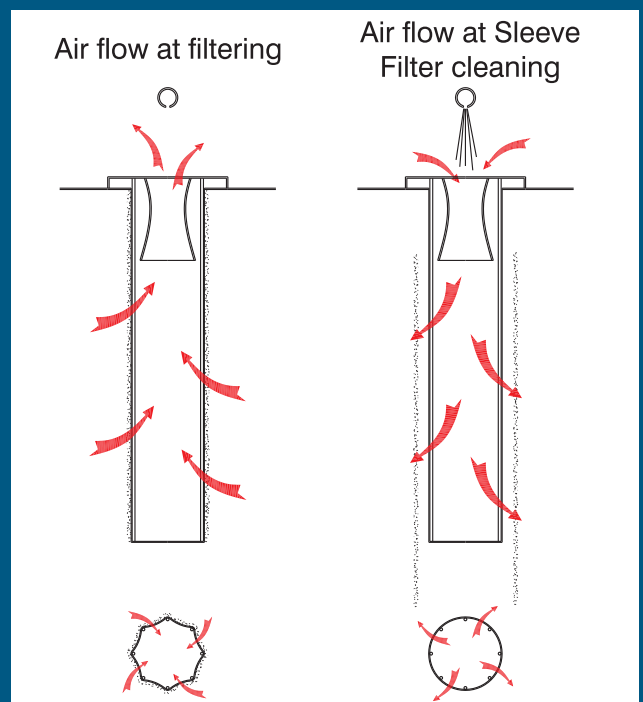

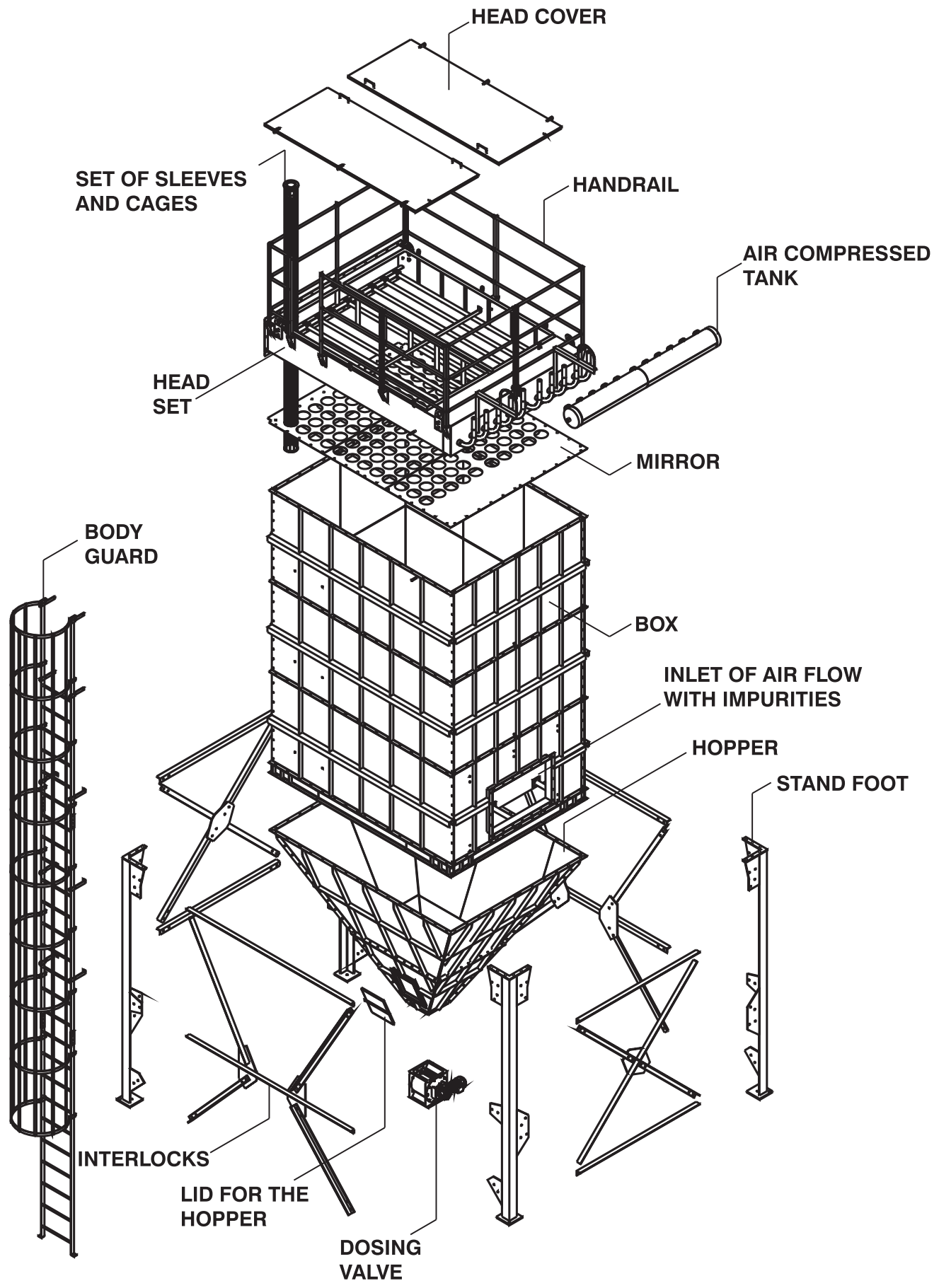

# SFMZ

## Sleeve Filter SFMZ

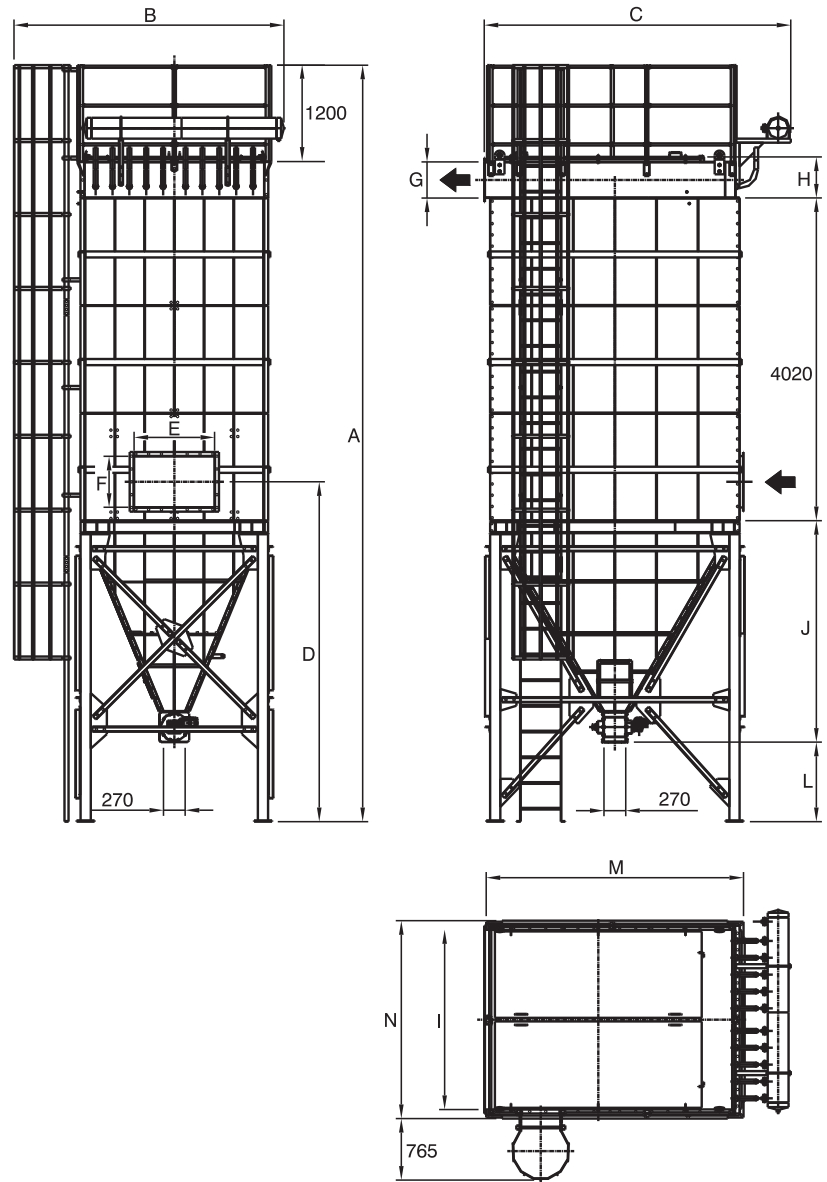

Models	Size	Filtering Area (m <sup>2</sup> )	Measures in (mm)													Weight (kg)
			A	B	C	D	E	F	G	H	I	J	L	M	N	
<b>SFMZ-130</b>	4 x 7	66	8570	2160	2830	3720	710	250	300	340	1000	1890	1160	2160	1090	1400
<b>SFMZ-230</b>	6 x 9	110	8680	2560	3080	3600	740	550	300	340	1400	2140	1020	2400	1490	2000
<b>SFMZ-370</b>	9 x 10	180	9025	3400	3080	3950	890	560	300	340	2240	2340	1160	2400	2330	3700
<b>SFMZ-500</b>	10 x 12	236	9420	3360	3820	4230	1000	630	440	510	2230	2760	990	3210	2460	4090
<b>SFMZ-760</b>	11 x 14	304	9710	3640	4150	4450	1290	690	400	590	2490	3000	940	3460	2600	4270
<b>SFMZ-840</b>	12 x 14	330	10050	3850	4150	4790	1510	750	440	650	2700	3340	940	3460	2810	4400
<b>SFMZ-1000</b>	15 x 14	415	10390	4480	4150	5130	2140	810	440	690	3120	3680	940	3460	3440	4670

PS: 1- All models include rotary valve, to discharge the impurities, powered by gear motor of 1,1 kW / 1,5 hp / IV poles.

2- Fan, connection pipes between filter and fan, chimney (optional) and noise attenuator (optional): they are specifics and dimensioned for each project.

.....  
Indústrias Machina Zaccaria S/A reserves the right to change the information contened in this catalog, including the color and details of the machine, without previous notice.



OUR EXPERIENCE MAKES THE DIFFERENCE

**INDÚSTRIAS MACHINA ZACCARIA S/A**  
Rua Laranjal, 180  
CEP: 13484-016 - Limeira - SP - Brasil  
Phone: (55.19) 3404-5745

[www.zaccaria.com.br](http://www.zaccaria.com.br)  
[comex@zaccaria.com.br](mailto:comex@zaccaria.com.br)

